

6.000" x 5.875" GunDRILL™ Eccentric Reamer, 4 blades, Steel, Spiral

Dimensional Data	Value	Unit	Value	Unit
Pass-through hole	5.875	inches	149.23	mm
Enlarged hole	6.000	inches	152.40	mm
Tool Total Length (L)	82.38	inches	2,092	mm
Fishing Neck Length (FN)	30.00	inches	762.00	mm
Bottom Neck Length minimum (BN)	34.50	inches	876.30	mm
Neck Diameter (D)	4.875	inches	123.83	mm
Tool Bore Diameter (d)	2.250	inches	57.15	mm
Wall Contact Length (B)	12.00	inches	304.80	mm
Weight (approx)	350	lbs	159	kg
Connection Type	XT39			
Connection Configuration	Box-Pin			

Performance Measures	
Cutting Direction	Bi-directional
Cutting Elements	13mm PDC Cutters
Reaming Elements	Tungsten Carbide Inserts
Blade Width (W)	1.60 inches 41 mm

Total Flow Area	
Total Flow Area (TFA), tool full-gauge	7.27 sq inches 4,690 sq mm
As Percentage	25

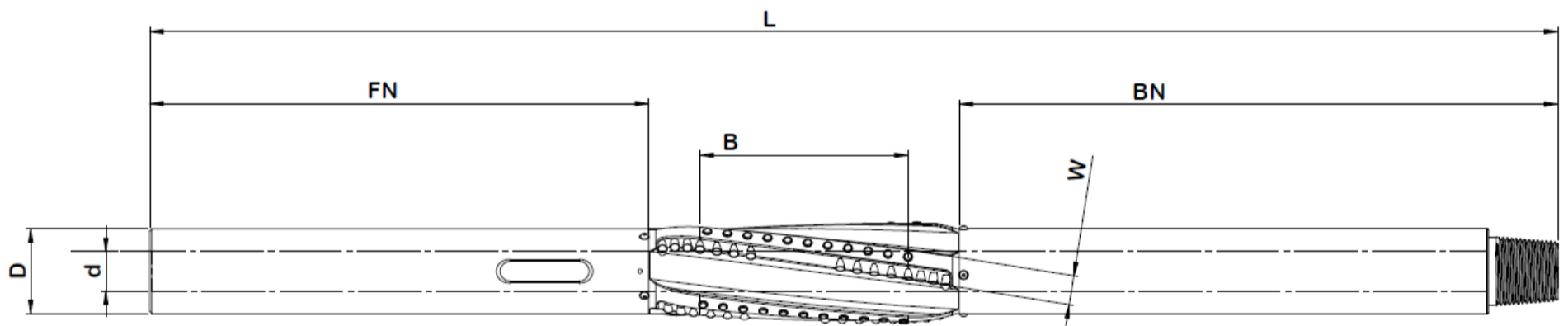

Custom sizes available upon request
 Fishing neck length and overall length are approximate figures and may vary slightly
 Dimensions are subject to change without prior notice
 Flow by area based on hole size equal to tool OD
 Rubicon drilling tools are designed and manufactured in conformance with API SPEC7-1 Latest Edition

Version: 2022-02-08

For more information

Visit www.innovex-inc.com or contact your local sales office.
 Domestic and international patents and trademarks granted and/or applied for where applicable.

THIS DOCUMENT IS PROVIDED IN STRICT CONFIDENCE AND MAY NOT BE DISCLOSED TO ANY THIRD PARTY OR USED FOR ANY OTHER PURPOSE WITHOUT THE EXPRESS WRITTEN PERMISSION OF INNOVEX.