

**8.500\"/>**

| Dimensional Data                | Value            | Unit   | Value  | Unit |
|---------------------------------|------------------|--------|--------|------|
| Pass-through hole               | 8.375            | inches | 212.73 | mm   |
| Enlarged hole                   | 8.500            | inches | 215.90 | mm   |
| Tool Total Length (L)           | 87.30            | inches | 2,217  | mm   |
| Fishing Neck Length (FN)        | 30.00            | inches | 762.00 | mm   |
| Bottom Neck Length minimum (BN) | 34.50            | inches | 876.30 | mm   |
| Neck Diameter (D)               | 6.750            | inches | 171.45 | mm   |
| Tool Bore Diameter (d)          | 2.350            | inches | 59.69  | mm   |
| Wall Contact Length (B)         | 13.00            | inches | 330.20 | mm   |
| Weight (approx)                 | 771              | lbs    | 350    | kg   |
| Connection Type                 | NC-50 (4 1/2 IF) |        |        |      |
| Connection Configuration        | Box-Pin          |        |        |      |

| Performance Measures |                          |        |    |    |
|----------------------|--------------------------|--------|----|----|
| Cutting Direction    | Bi-directional           |        |    |    |
| Cutting Elements     | 13mm PDC Cutters         |        |    |    |
| Reaming Elements     | Tungsten Carbide Inserts |        |    |    |
| Blade Width (W)      | 2.63                     | inches | 67 | mm |

| Total Flow Area                        |       |           |       |       |
|--|-------|-----------|-------|-------|
| Total Flow Area (TFA), tool full-gauge | 13.08 | sq inches | 8,439 | sq mm |
| As Percentage                          | 23%   |           |       |       |

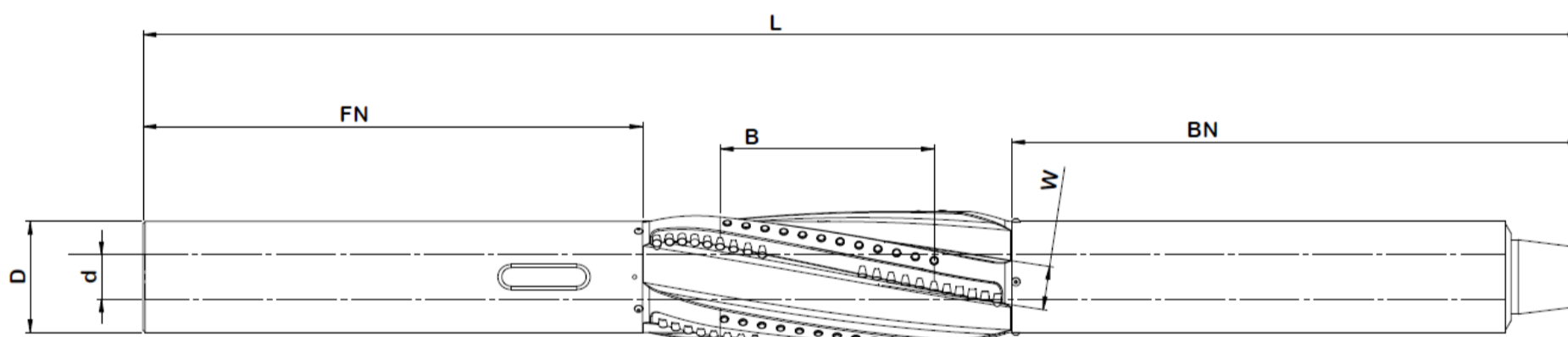

Custom sizes available upon request  
 Fishing neck length and overall length are approximate figures and may vary slightly  
 Dimensions are subject to change without prior notice  
 Flow by area based on hole size equal to tool OD  
 Rubicon drilling tools are designed and manufactured in conformance with API SPEC7-1 Latest Edition

Version: 2022-02-04

**For more information**

Visit [www.innovex-inc.com](http://www.innovex-inc.com) or contact your local sales office.  
 Domestic and international patents and trademarks granted and/or applied for where applicable.

**THIS DOCUMENT IS PROVIDED IN STRICT CONFIDENCE AND MAY NOT BE DISCLOSED TO ANY THIRD PARTY OR USED FOR ANY OTHER PURPOSE WITHOUT THE EXPRESS WRITTEN PERMISSION OF INNOVEX.**